

$\Delta L_w$  18 dB

Very high density foam



in accordance with the MMFA\* criterias

# insulit LVT 1.0

## High-performance acoustic underlay

REDUCES IMPACT AND WALKING SOUNDS UNDER VINYL FLOORING

### Installation

- UNDER LVT FLOORING:
  - RIGID
  - FLEXIBLE
  - ...

### Advantages

- Excellent performance against impact noises
- Reduces walking sounds
- Available in rolls, ensuring an easy and fast installation
- Resistant against perforations, withstands punctual loads
- Made for click systems
- Flattens out small floor unevennesses
- Compatible with floor heating installations
- Thermal insulation properties



Impact sound insulation  
 $\Delta L_w$  18dB

EN ISO 10140-3 / EN ISO 717-2



Radiated walking sounds reduced by  
40%

SAAG WS 021029-5 F1

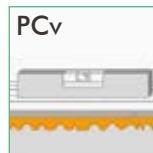

Levelling-out of floor unevennesses

0,5 mm

EN 16354: 2018

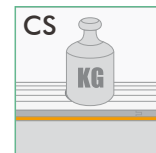

Compressive strength

$\geq 400$  kPa

EN 826

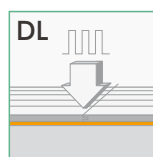

Dynamic load

0.1-75 kPa  
 $c \geq 200.000$   
 $\Delta d \leq 0,5$  mm

EN 13793

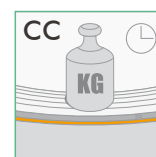

High compressive creep resistance  
 $\geq 40$  kPa

Max 0,5 mm (over 10 years)  
EN 1606

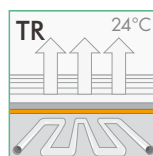

Compatible with floor heating

$R = 0,016$  m<sup>2</sup>K/W

EN 12667 / EN 12664



Excellent water vapour resistance

$SD = 75$  m

EN 12086



Reaction to fire

$E_{fl}$  class

EN ISO 11925-2 ; EN classification  
13501-1, Table 2

# insulit LVT 1.0

## Description

insulit LVT 1.0 is a thin acoustic underlay for a rigid or flexible LVT flooring with click systems. It meets the highest requirements of the association dedicated to multi-layer and modular floor coverings, the MMFA (\*Multi-layer Modular Flooring Association). This underlay will allow to keep all the qualities of your LVT floor while reducing the transmission of impact noise between floor levels and while reducing footsteps sounds in the area where the underlay is installed.

insulit LVT 1.0 is made of a very high density polyolefin foam with closed micro cells. It is produced without CFCs or HCFCs and contains no harmful substance.

## Installation

**Floating installation :** The floor should be smooth and carefully brushed. Unroll the strips edge to edge and make sure it is raised laterally against the walls. Place the floor covering and, afterwards only, cut off the excess insulit LVT. Mount the plinth on the wall slightly higher than the floating floor in order to avoid contact. Make a flexible joint between the plinth and the floor covering.

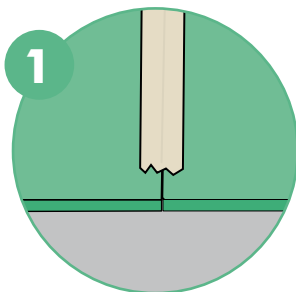

1  
Install the strips edge to edge

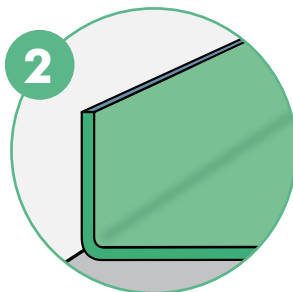

2  
Raise the insulit LVT alongside the wall.

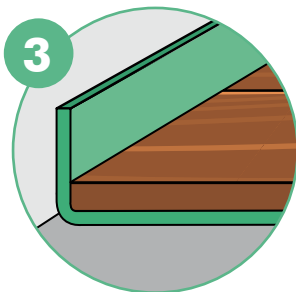

3  
Install the LVT flooring while keeping the underlay on the wall

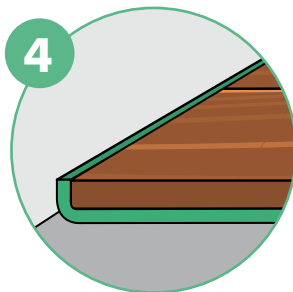

4  
Cut-off the excess insulit LVT.

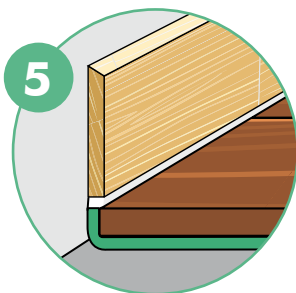

5  
Mount the plinth a few millimetres above the parquet floor and make a flexible joint.



## Characteristics

**Material :**  
High density polyolefin

**Thickness :**  $\pm 1$  mm\*

**Acoustic insulation :**  $\Delta L_w$  18 dB

**Walking sound reduction :**  
up to 40% inside the room where the sound is emitted

**R value :** 0,016 m<sup>2</sup>K/W

**Reaction to fire :** E<sub>fl</sub> class

**Colour :** Green

**Packaging :**  
Roll of 15 m x 1 m

**Pallet :** 35 rolls = 525 m<sup>2</sup>

\*10% tolerance



insulco sprl • Z.I. Sud (1) • Rue Buisson aux Loups, 1a • 1400 Nivelles • BELGIUM  
Phone : +32 67 41 16 10 • Fax : +32 67 41 16 16 • insulco@insulco.be  
Website : [www.insulco.eu](http://www.insulco.eu)

All information provided is the result of studies and experience. It is communicated in good faith, but may under no circumstances constitute a guarantee on our part, nor engage our liability, even if the rights of third parties are violated. Responsible publisher : Insulco sprl, rue Buisson aux Loups 1a, 1400 Nivelles - BELGIUM. Edition 10/2019

**insulco**  
insulation products